

12-11-18

ORDINANCE NO. 31069

An ordinance amending Article 751, "PD 751," of Chapter 51P, "Dallas Development Code: Planned Development District Regulations," of the Dallas City Code; providing a new Tract 1A development plan/Tract 1, Tract 2 conceptual plan; providing a new landscape plan; amending Ordinance No. 26433 passed by the Dallas City council on August 23, 2006 by providing a revised property description; providing a penalty not to exceed \$2,000; providing a saving clause; providing a severability clause; and providing an effective date.

WHEREAS, the city plan commission and the city council, in accordance with the Charter of the City of Dallas, the state law, and the ordinances of the City of Dallas, have given the required notices and have held the required public hearings regarding this amendment to the Dallas City Code; and

WHEREAS, the city council finds that it is in the public interest to amend Article 751 as specified in this ordinance; Now, Therefore,

BE IT ORDAINED BY THE CITY COUNCIL OF THE CITY OF DALLAS:

SECTION 1. That the Tract 1A development plan/Tract 1, Tract 2 conceptual plan, Exhibit 751A of Article 751, "PD 751," of Chapter 51P of the Dallas City Code, is replaced by the Exhibit 751A attached to this ordinance.

SECTION 2. That the landscape plan, Exhibit 751B of Article 751, "PD 751," of Chapter 51P of the Dallas City Code, is replaced by the Exhibit 751B attached to this ordinance.

SECTION 3. That development of this district must comply with the full-scale versions of Exhibit 751A (development plan) and Exhibit 751B (landscape plan) attached to this ordinance. Reduced-sized versions of these plans shall be provided in Chapter 51P. Permits shall be issued based on information provided on the full-scale versions of the plans.

SECTION 4. That Exhibit A (property description) attached to Ordinance No. 26433 is replaced by the Exhibit A attached to this ordinance.

SECTION 5. That a person who violates a provision of this ordinance, upon conviction, is punishable by a fine not to exceed \$2,000.

SECTION 6. That Chapter 51P of the Dallas City Code, as amended, shall remain in full force and effect, save and except as amended by this ordinance.

SECTION 7. That the terms and provisions of this ordinance are severable and are governed by Section 1-4 of Chapter 1 of the Dallas City Code, as amended.

SECTION 8. That this ordinance shall take effect immediately from and after its passage and publication, in accordance with the Charter of the City of Dallas, and it is accordingly so ordained.

APPROVED AS TO FORM:

CHRISTOPHER J. CASO, Interim City Attorney

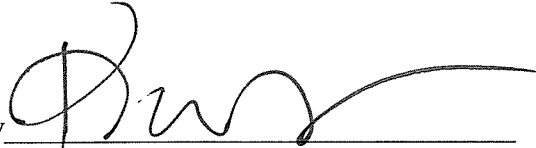
By   
Assistant City Attorney

Passed DEC 12 2018

**EXHIBIT A**  
PD 751 Property Descriptions

**PERIMETER**

**TRACT 1**

*(ORD 27544\_Z089-121\_Tract expansion)*

Being a tract of land situated in the J.R. Bell Survey, Abstract No. 123, Dallas County, Texas, and being all of Lot 1, Block K/7554 of Salehoun Addition, an addition to the City of Dallas, Dallas County, Texas, according to the plat thereof recorded in Volume 2004153, Page 231 of the Map Records of Dallas County, Texas and being all of Lots 2 thru 9, Block K/7554 of Wheatland Towne Crossing No. 2 Addition, an Addition to the City of Dallas, Dallas County, Texas, according to the plat thereof recorded in Instrument No. 20070442314 of the Map Records of Dallas County, Texas, and being more particularly described as follows;

BEGINNING at a 5/8 inch iron rod found for the northern most end of a corner clip at the intersection of the southerly right-of-way line of Cliff Creek Crossing Drive (a 64 foot right-of-way) and the southeasterly right-of-way line of Bainbridge Drive (a 64 foot right-of-way);

THENCE South 63°08'48" East, along said southerly right-of-way line of Cliff Creek Crossing Drive, for a distance of 1637.15 feet to a 5/8 inch iron rod found for corner, from which a ½ inch rod found bears South 09°51'02" East, for a distance of 1.34 feet, said point being the beginning of a curve to the left having a radius of 622.00 feet, a central angle of 28°12'31", a chord bearing of South 77°15'04" East, and a chord distance of 303.15 feet;

THENCE along said southerly right-of-way line of Cliff Creek Crossing Drive and curve to the left for an arc distance of 306.23 feet to a 5/8 inch iron rod for corner from which a ½ inch iron rod found bears North 13°53'33" West for a distance of 1.76 feet, said point also being in the northerly end of a corner clip at the intersection of said southerly right-of-way line of Cliff Creek Crossing Drive and the west right-of-way line of Chrysalis Drive;

THENCE South 46°34'36" East, along said corner clip for a distance of 14.15 feet to a 5/8 inch iron rod found for corner in the west right-of-way line of Chrysalis Drive (a 64 foot right-of-way);

THENCE along said west right-of-way line of Chrysalis Drive, the following courses and distances numbered (1) through (4);

- 1) South 01°36'22" East, for a distance of 68.95 feet to a 5/8 inch iron rod found for corner at the beginning of a curve to the left having a radius of 622.00 feet, a central angle of 30°53'47", a chord bearing of South 17°03'16" East and a chord distance of 331.36 feet;
- 2) Along said curve to the left an arc distance of 335.41 feet to a 5/8 inch iron rod found for corner at the beginning of a curve to the right having a radius of 558.00 feet, a central angle

of  $31^{\circ}03'02''$ , a chord bearing of South  $16^{\circ}58'38''$  East, and a chord distance of 298.71 feet;

- 3) Along said curve to the right for an arc distance of 302.40 feet to a 5/8 inch iron rod found for corner;
- 4) South  $01^{\circ}27'04''$  East, for a distance of 29.00 feet to a 5/8 inch iron rod for corner in the northerly end of a corner clip at the intersection of said west right-of-way line of Chrysalis Drive and the north right-of-way line of Wheatland Road;

THENCE South  $43^{\circ}32'56''$  West, along said corner clip for a distance of 14.14 feet to a 5/8 inch iron rod found for corner in the north right-of-way line of Wheatland Road (a 100 foot right-of-way);

THENCE South  $88^{\circ}32'56''$  West, along said north right-of-way line of Wheatland Road for a distance of 626.62 feet to a 5/8 inch iron rod found for corner;

THENCE North  $78^{\circ}31'19''$  West, for a distance of 94.27 feet to a 5/8 inch iron rod found for corner in the northerly right-of-way line of Interstate Highway No. 20 (a variable width right-of-way);

THENCE North  $63^{\circ}16'31''$  West, along said northerly right-of-way line of Interstate Highway No. 20, for a distance of 1003.74 feet to a 5/8 inch iron rod found for corner;

THENCE North  $64^{\circ}07'05''$  West, along said northerly right-of-way line of Interstate Highway No. 20, for a distance of 763.77 feet to a 5/8 inch iron rod found for corner in the southern most end of a corner clip at the intersection of the northerly right-of-way line of Interstate Highway No. 20 and the southeasterly right-of-way line of Bainbridge Drive;

THENCE North  $19^{\circ}07'06''$  West, along said corner clip for a distance of 14.14 feet to a 5/8 inch iron rod found for corner in the southeasterly right-of-way line of Bainbridge Drive (a 64 foot right-of-way);

THENCE North  $25^{\circ}52'54''$  East, along said southeasterly right-of-way line of Bainbridge Drive, for a distance of 801.68 feet to a point for corner from which a 5/8" iron rod found bears South  $82^{\circ}04'55''$  West for a distance of 0.32 feet, said point being at the southerly end of the aforementioned corner clip at the intersection of the southerly right-of-way line of Cliff Creek Crossing Drive and the southeasterly right-of-way line of Bainbridge Drive;

THENCE North  $71^{\circ}22'03''$  East, along said corner clip for a distance of 14.02 feet to the POINT OF BEGINNING AND CONTAINING WITHIN THESE METES AND BOUNDS, 40.7861 ACRES OF LAND, MORE OR LESS. Bearings based on the southerly right-of-way line of Cliff Creek Crossing Drive (a 64 foot right-of-way) as per the final plat of Lyons-Lindley Addition, an addition to the City of Dallas, Dallas County, Texas, as recorded in Volume 86083, Page 4630, of the Map Records of Dallas County, Texas.

31069

**TRACT 2***(ORD 26433\_Z056-247 established)*

Being a tract of land situated in the J.R. BELL SURVEY, Abstract No. 123, Dallas County, Texas, and also being a portion of a tract of land conveyed to HAMPTON/WHEATLAND, LTD, by deed, as recorded in Volume 94084, Page 03043, of the Deed Records of Dallas County, Texas, and being more particularly described as follows:

COMMENCING at a 1/2 inch iron rod found for corner at the most southern end of a corner clip at the intersection of the southerly right-of-way line of CLIFF CREEK CROSSING, (64 feet right-of-way) and the westerly right-of-way line of HAMPTON ROAD, (100 feet right-of-way);

THENCE, along said westerly right-of-way line of HAMPTON ROAD, (100 feet right-of-way), South  $01^{\circ} 36' 22$  East, a distance of 132.07 feet, to a point, said point being the beginning of a curve to the left, said curve having a radius of 2945.11 feet and a chord bearing South  $01^{\circ} 40' 59$ " East, a distance of 7.93 feet;

THENCE, along said curve to the left, through a central angle of  $00^{\circ} 09' 15$ " and an arc length of 7.93 feet, to a 1/2 inch iron rod set for corner and PLACE OF BEGINNING, said iron rod being the beginning of a curve to the left, said curve having a radius of 2945.11 feet and a chord bearing South  $04^{\circ} 03' 54$ " East, a distance of 235.86 feet;

THENCE, along said curve to the left, through a central angle of  $04^{\circ} 36' 34$ " and an arc length of 236.93 feet, to a 1/2 inch iron rod set for corner and beginning of a curve to the right, said curve having a radius of 2845.11 feet and a chord bearing South  $06^{\circ} 10' 36$ " East, a distance of 19.15 feet;

THENCE, along said curve to the right, through a central angle of  $00^{\circ} 23' 08$ " and an arc length of 19.15 feet, to a 1/2 inch iron rod set for corner and beginning of a curve to the right, said curve having a radius of 300.00 feet and a chord bearing South  $02^{\circ} 33' 03$ " West, a distance of 40.19 feet;

THENCE, along said curve to the right, through a central angle of  $07^{\circ} 40' 57$ " and an arc length of 40.22 feet, to a 1/2 inch iron rod set for corner and beginning of a curve to the left, said curve having a radius of 150.00 feet and a chord bearing South  $02^{\circ} 58' 23$ " West, a distance of 31.62 feet;

THENCE, along said curve to the left, through a central angle of  $12^{\circ} 06' 06$ " and an arc length of 31.68 feet, to a 1/2 inch iron rod set for corner and beginning of a curve to the right, said curve having a radius of 2835.11 feet and a chord bearing South  $03^{\circ} 04' 40$ " East, a distance of 145.62 feet;

THENCE, along said curve to the right, through a central angle of  $02^{\circ} 56' 36$ " and an arc length of 145.64 feet, to a 1/2 inch iron rod set for corner in said westerly right-of-way line of HAMPTON ROAD, (100 feet right-of-way), South  $01^{\circ} 36' 22$ " East, a distance of

93.81 feet, to a point for corner at the northerly end of a corner clip;

THENCE, along said corner clip, South 43° 28' 33" West a distance of 14.12 feet., to a 1/2 inch iron rod set for corner in the north right-of-way line of WHEATLAND DRIVE, (100 feet right-of-way);

THENCE, along said north right-of-way line of WHEATLAND DRIVE, (100 feet right-of-way) South 88° 32' 56" West, a distance of 416.78 feet., to a point for corner from which a 1/2 inch iron rod found bears North 62° 16' 13" West, a distance of 0.36 feet, said point being at the southerly end of a corner clip;

THENCE, along said corner clip, North 46° 27' 04" West, a distance of 14.14 feet, to a 1/2 inch iron rod set for corner in the easterly right-of-way line of CHRYSALIS DRIVE, (64 feet right-of-way);

THENCE, along said easterly right-of-way line of CHRYSALIS DRIVE, (64 feet right-of-way), North 01° 27' 04" West, a distance of 29.00 feet, to a point for corner from which a 1/2 inch iron rod found bears South 64° 01' 16" West, a distance of 0.31 feet, said point being the beginning of a curve to the left; said curve having a radius of 622.00 feet and a chord bearing North 16° 58' 36" West, a distance of 332.98 feet;

THENCE, along said curve to the left, through a central angle of 31° 03' 05" and an arc length of 337.09 feet, to a point for corner from which a 1/2 inch, iron rod found bears South 72° 01' 48" West, a distance of 0.30 feet, said point being the beginning a curve to the right, said curve having a radius of 558.00 feet and a chord bearing North 17° 03' 15" West, a distance of 297.26;

THENCE, along said curve to the right, through a central angle of 30° 53' 46" and an arc length of 300.89 feet, to a 5/8 inch iron rod found for corner in said easterly right-of-way line of CHRYSALIS DRIVE, (64 feet right-of-way);

THENCE, along said easterly right-of-way line of CHRYSALIS DRIVE, (64 feet right-of-way), North 01° 36' 22" West, a distance of 68.95 feet; to a 1/2 inch iron rod found for corner at the southerly end of a corner clip;

THENCE, along said corner clip, North 43° 23' 38" East, a distance of 14.14 feet, to a 1/2 inch iron rod found for corner in said southerly right-of-way line of CLIFF CREEK CROSSING, (64 feet R.O.W.);

THENCE, along said southerly right-of-way line of CLIFF CREEK CROSSING, (64 feet right-of-way), North 88° 23' 38" East, a distance of 284.11 feet, to a 1/2 inch iron rod set for corner;

THENCE, departing said southerly right-of-way line of CLIFF CREEK CROSSING, (64 feet right-of-way), South 01° 36' 22" East, a distance of 150.00 feet., to a 1/2 inch iron rod set for corner;

THENCE, North 88° 23' 38" East, a distance of 300.01 feet, to the POINT OF BEGINNING;

CONTAINING within these metes and bounds, 7.613 acres or 331,636 square feet of land, more or less. Bearings based upon the southerly right-of-way line of CLIFF CREEK CROSSING, (64 feet right-of-way), as per final plat of LYONS-LINDSLEY ADDITION, an addition to the City of Dallas, Dallas County, Texas, as recorded in Volume 86083, Page 4630, of the Deed Records of Dallas County, Texas.

### **TRACT 1 (Tracts)**

#### **Tract 1A**

Lot 2, Block K/7554 of WHEATLAND TOWNE CROSSING NO. 2 ADDITION, an addition to the City of Dallas, Dallas County, Texas according to the FINAL Plat recorded under Clerk's File No. 20070443314, Real Property Records, Dallas County, Texas.

#### **Tract 1B**

Lot 3, Block K/7554 of WHEATLAND TOWNE CROSSING NO. 2 ADDITION, an addition to the City of Dallas, Dallas County, Texas according to the FINAL Plat recorded under Clerk's File No. 20070443314, Real Property Records, Dallas County, Texas.

#### **Tract 1C**

Lot 4, Block K/7554 of WHEATLAND TOWNE CROSSING NO. 2 ADDITION, an addition to the City of Dallas, Dallas County, Texas according to the FINAL Plat recorded under Clerk's File No. 20070443314, Real Property Records, Dallas County, Texas.

#### **Tract 1D**

Lot 5, Block K/7554 of WHEATLAND TOWNE CROSSING NO. 2 ADDITION, an addition to the City of Dallas, Dallas County, Texas according to the FINAL Plat recorded under Clerk's File No. 20070443314, Real Property Records, Dallas County, Texas.

#### **Tract 1E**

Lot 6, Block K/7554 of WHEATLAND TOWNE CROSSING NO. 2 ADDITION, an addition to the City of Dallas, Dallas County, Texas according to the FINAL Plat recorded under Clerk's File No. 20070443314, Real Property Records, Dallas County, Texas.

#### **Tract 1F**

Lot 7A, Block K/7554 of WHEATLAND TOWNE CROSSING NO. 4 ADDITION, an addition to the City of Dallas, Dallas County, Texas according to the FINAL Plat recorded under Clerk's File No. 201200044503, Real Property Records, Dallas County, Texas.

**Tract 1G**

Lot 1B, Block K/7554 of WHEATLAND TOWNE CROSSING NO. 4 ADDITION, an addition to the City of Dallas, Dallas County, Texas according to the FINAL Plat recorded under Clerk's File No. 201200044503, Real Property Records, Dallas County, Texas.

**Tract 1H**

Lots 1D and 1C, Block K/7554 of WHEATLAND TOWNE CROSSING NO. 5 ADDITION, an addition to the City of Dallas, Dallas County, Texas according to the FINAL Plat recorded under Clerk's File No. 201300243810, Real Property Records, Dallas County, Texas.

**TRACT 2 (Tracts)****Tract 2A**

Lots 1 and 4, Block L/7554 of WHEATLAND TOWNE CROSSING NO. 3 ADDITION, an addition to the City of Dallas, Dallas County, Texas according to the FINAL Plat recorded under Clerk's File No. 200900168527, Real Property Records, Dallas County, Texas.

**Tract 2B**

Lot 2, Block L/7554 of WHEATLAND TOWNE CROSSING NO. 3 ADDITION, an addition to the City of Dallas, Dallas County, Texas according to the FINAL Plat recorded under Clerk's File No. 200900168527, Real Property Records, Dallas County, Texas.

**Tract 2C**

Lot 3, Block L/7554 of WHEATLAND TOWNE CROSSING NO. 3 ADDITION, an addition to the City of Dallas, Dallas County, Texas according to the FINAL Plat recorded under Clerk's File No. 200900168527, Real Property Records, Dallas County, Texas.





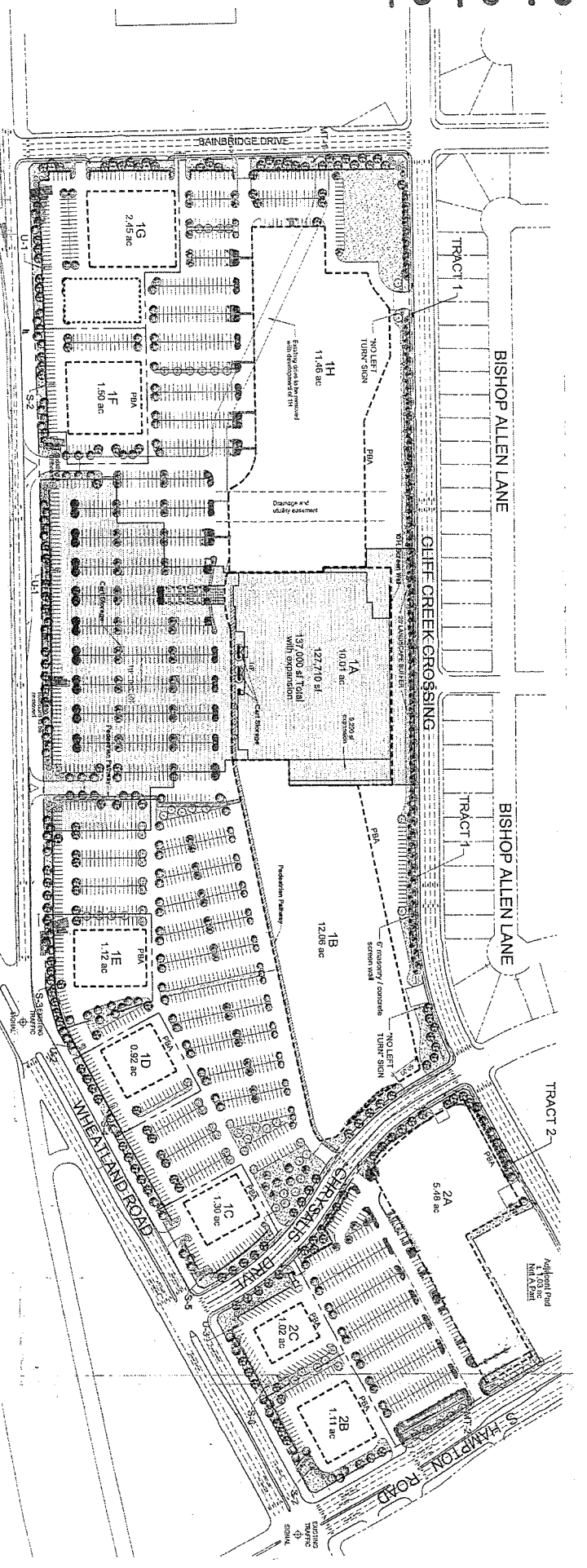

LANDSCAPE MANIPULATIONS OUTLOT 10	LANDSCAPE MANIPULATIONS OUTLOT 11	LANDSCAPE MANIPULATIONS OUTLOT 12	LANDSCAPE MANIPULATIONS OUTLOT 13	LANDSCAPE MANIPULATIONS OUTLOT 14	LANDSCAPE MANIPULATIONS OUTLOT 15	LANDSCAPE MANIPULATIONS OUTLOT 16	LANDSCAPE MANIPULATIONS OUTLOT 17	LANDSCAPE MANIPULATIONS OUTLOT 18	LANDSCAPE MANIPULATIONS OUTLOT 19	LANDSCAPE MANIPULATIONS OUTLOT 20	LANDSCAPE MANIPULATIONS OUTLOT 21	LANDSCAPE MANIPULATIONS OUTLOT 22	LANDSCAPE MANIPULATIONS OUTLOT 23	LANDSCAPE MANIPULATIONS OUTLOT 24	LANDSCAPE MANIPULATIONS OUTLOT 25	LANDSCAPE MANIPULATIONS OUTLOT 26	LANDSCAPE MANIPULATIONS OUTLOT 27	LANDSCAPE MANIPULATIONS OUTLOT 28	LANDSCAPE MANIPULATIONS OUTLOT 29	LANDSCAPE MANIPULATIONS OUTLOT 30
<p><b>LANDSCAPE MANIPULATIONS OUTLOT 10</b></p> <p>DATE: 07/11/2018            TIME: 10:00 AM            PROJECT: 181848            SHEET: 10 OF 30            DRAWN BY: [Name]            CHECKED BY: [Name]            APPROVED BY: [Name]</p>	<p><b>LANDSCAPE MANIPULATIONS OUTLOT 11</b></p> <p>DATE: 07/11/2018            TIME: 10:00 AM            PROJECT: 181848            SHEET: 11 OF 30            DRAWN BY: [Name]            CHECKED BY: [Name]            APPROVED BY: [Name]</p>	<p><b>LANDSCAPE MANIPULATIONS OUTLOT 12</b></p> <p>DATE: 07/11/2018            TIME: 10:00 AM            PROJECT: 181848            SHEET: 12 OF 30            DRAWN BY: [Name]            CHECKED BY: [Name]            APPROVED BY: [Name]</p>	<p><b>LANDSCAPE MANIPULATIONS OUTLOT 13</b></p> <p>DATE: 07/11/2018            TIME: 10:00 AM            PROJECT: 181848            SHEET: 13 OF 30            DRAWN BY: [Name]            CHECKED BY: [Name]            APPROVED BY: [Name]</p>	<p><b>LANDSCAPE MANIPULATIONS OUTLOT 14</b></p> <p>DATE: 07/11/2018            TIME: 10:00 AM            PROJECT: 181848            SHEET: 14 OF 30            DRAWN BY: [Name]            CHECKED BY: [Name]            APPROVED BY: [Name]</p>	<p><b>LANDSCAPE MANIPULATIONS OUTLOT 15</b></p> <p>DATE: 07/11/2018            TIME: 10:00 AM            PROJECT: 181848            SHEET: 15 OF 30            DRAWN BY: [Name]            CHECKED BY: [Name]            APPROVED BY: [Name]</p>	<p><b>LANDSCAPE MANIPULATIONS OUTLOT 16</b></p> <p>DATE: 07/11/2018            TIME: 10:00 AM            PROJECT: 181848            SHEET: 16 OF 30            DRAWN BY: [Name]            CHECKED BY: [Name]            APPROVED BY: [Name]</p>	<p><b>LANDSCAPE MANIPULATIONS OUTLOT 17</b></p> <p>DATE: 07/11/2018            TIME: 10:00 AM            PROJECT: 181848            SHEET: 17 OF 30            DRAWN BY: [Name]            CHECKED BY: [Name]            APPROVED BY: [Name]</p>	<p><b>LANDSCAPE MANIPULATIONS OUTLOT 18</b></p> <p>DATE: 07/11/2018            TIME: 10:00 AM            PROJECT: 181848            SHEET: 18 OF 30            DRAWN BY: [Name]            CHECKED BY: [Name]            APPROVED BY: [Name]</p>	<p><b>LANDSCAPE MANIPULATIONS OUTLOT 19</b></p> <p>DATE: 07/11/2018            TIME: 10:00 AM            PROJECT: 181848            SHEET: 19 OF 30            DRAWN BY: [Name]            CHECKED BY: [Name]            APPROVED BY: [Name]</p>	<p><b>LANDSCAPE MANIPULATIONS OUTLOT 20</b></p> <p>DATE: 07/11/2018            TIME: 10:00 AM            PROJECT: 181848            SHEET: 20 OF 30            DRAWN BY: [Name]            CHECKED BY: [Name]            APPROVED BY: [Name]</p>	<p><b>LANDSCAPE MANIPULATIONS OUTLOT 21</b></p> <p>DATE: 07/11/2018            TIME: 10:00 AM            PROJECT: 181848            SHEET: 21 OF 30            DRAWN BY: [Name]            CHECKED BY: [Name]            APPROVED BY: [Name]</p>	<p><b>LANDSCAPE MANIPULATIONS OUTLOT 22</b></p> <p>DATE: 07/11/2018            TIME: 10:00 AM            PROJECT: 181848            SHEET: 22 OF 30            DRAWN BY: [Name]            CHECKED BY: [Name]            APPROVED BY: [Name]</p>	<p><b>LANDSCAPE MANIPULATIONS OUTLOT 23</b></p> <p>DATE: 07/11/2018            TIME: 10:00 AM            PROJECT: 181848            SHEET: 23 OF 30            DRAWN BY: [Name]            CHECKED BY: [Name]            APPROVED BY: [Name]</p>	<p><b>LANDSCAPE MANIPULATIONS OUTLOT 24</b></p> <p>DATE: 07/11/2018            TIME: 10:00 AM            PROJECT: 181848            SHEET: 24 OF 30            DRAWN BY: [Name]            CHECKED BY: [Name]            APPROVED BY: [Name]</p>	<p><b>LANDSCAPE MANIPULATIONS OUTLOT 25</b></p> <p>DATE: 07/11/2018            TIME: 10:00 AM            PROJECT: 181848            SHEET: 25 OF 30            DRAWN BY: [Name]            CHECKED BY: [Name]            APPROVED BY: [Name]</p>	<p><b>LANDSCAPE MANIPULATIONS OUTLOT 26</b></p> <p>DATE: 07/11/2018            TIME: 10:00 AM            PROJECT: 181848            SHEET: 26 OF 30            DRAWN BY: [Name]            CHECKED BY: [Name]            APPROVED BY: [Name]</p>	<p><b>LANDSCAPE MANIPULATIONS OUTLOT 27</b></p> <p>DATE: 07/11/2018            TIME: 10:00 AM            PROJECT: 181848            SHEET: 27 OF 30            DRAWN BY: [Name]            CHECKED BY: [Name]            APPROVED BY: [Name]</p>	<p><b>LANDSCAPE MANIPULATIONS OUTLOT 28</b></p> <p>DATE: 07/11/2018            TIME: 10:00 AM            PROJECT: 181848            SHEET: 28 OF 30            DRAWN BY: [Name]            CHECKED BY: [Name]            APPROVED BY: [Name]</p>	<p><b>LANDSCAPE MANIPULATIONS OUTLOT 29</b></p> <p>DATE: 07/11/2018            TIME: 10:00 AM            PROJECT: 181848            SHEET: 29 OF 30            DRAWN BY: [Name]            CHECKED BY: [Name]            APPROVED BY: [Name]</p>	<p><b>LANDSCAPE MANIPULATIONS OUTLOT 30</b></p> <p>DATE: 07/11/2018            TIME: 10:00 AM            PROJECT: 181848            SHEET: 30 OF 30            DRAWN BY: [Name]            CHECKED BY: [Name]            APPROVED BY: [Name]</p>

Approved  
 City Plan Commission  
 October 18, 2018

Exhibit 751B  
 Planned Development  
 District No. 751

IH 20 AT Wheatland Road DALLAS, TEXAS

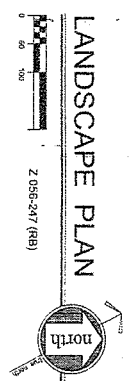

**PLANT LEGEND**

[Symbol]	ORANGE BLOSSOM TREE, 6 FT.
[Symbol]	ORANGE BLOSSOM TREE, 8 FT.
[Symbol]	ORANGE BLOSSOM TREE, 10 FT.
[Symbol]	ORANGE BLOSSOM TREE, 12 FT.
[Symbol]	ORANGE BLOSSOM TREE, 14 FT.
[Symbol]	ORANGE BLOSSOM TREE, 16 FT.
[Symbol]	ORANGE BLOSSOM TREE, 18 FT.
[Symbol]	ORANGE BLOSSOM TREE, 20 FT.
[Symbol]	ORANGE BLOSSOM TREE, 22 FT.
[Symbol]	ORANGE BLOSSOM TREE, 24 FT.
[Symbol]	ORANGE BLOSSOM TREE, 26 FT.
[Symbol]	ORANGE BLOSSOM TREE, 28 FT.
[Symbol]	ORANGE BLOSSOM TREE, 30 FT.
[Symbol]	ORANGE BLOSSOM TREE, 32 FT.
[Symbol]	ORANGE BLOSSOM TREE, 34 FT.
[Symbol]	ORANGE BLOSSOM TREE, 36 FT.
[Symbol]	ORANGE BLOSSOM TREE, 38 FT.
[Symbol]	ORANGE BLOSSOM TREE, 40 FT.
[Symbol]	ORANGE BLOSSOM TREE, 42 FT.
[Symbol]	ORANGE BLOSSOM TREE, 44 FT.
[Symbol]	ORANGE BLOSSOM TREE, 46 FT.
[Symbol]	ORANGE BLOSSOM TREE, 48 FT.
[Symbol]	ORANGE BLOSSOM TREE, 50 FT.

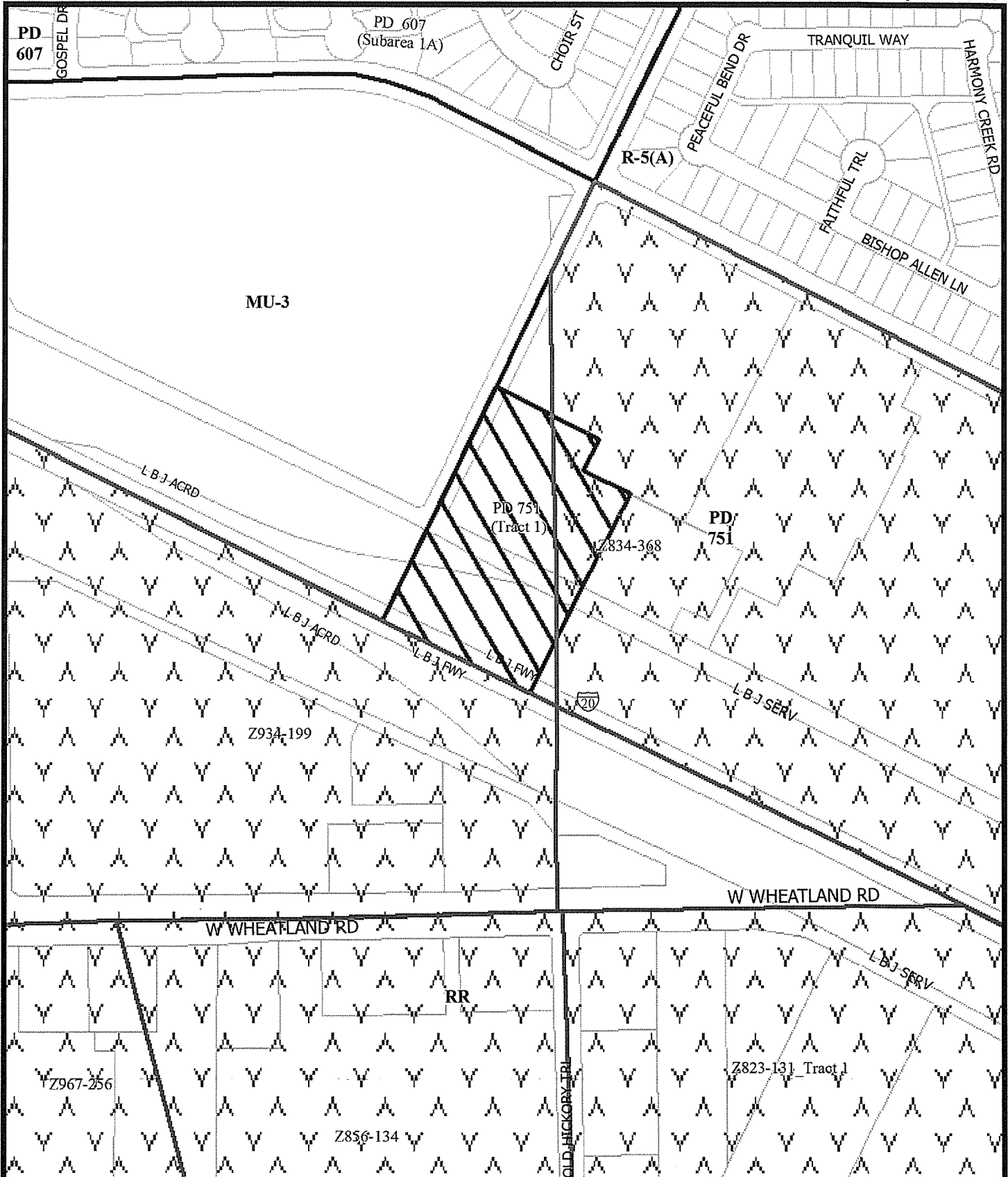

1:3,600

# ZONING MAP

Case no: Z178-346

Date: 11/13/2018

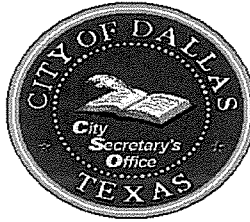

## PROOF OF PUBLICATION – LEGAL ADVERTISING

The legal advertisement required for the noted ordinance was published in the Dallas Morning News, the official newspaper of the city, as required by law, and the Dallas City Charter, Chapter XVIII, Section 7.

DATE ADOPTED BY CITY COUNCIL DEC 12 2018

ORDINANCE NUMBER 31069

DATE PUBLISHED DEC 15 2018

ATTESTED BY: